

RegEd Job Aid

Follow the steps below to complete the carrier-specific product trainings for Protective.

1. Log in to RegEd

Go to <https://secure.reged.com/TrainingPlatform/> to log in to RegEd.

For first time users, click **Register online** located under the Producers Get Started Box.



2. Producer status

The product courses may already be listed under the **Carrier Specific Product Training** section. If the courses are not listed, click the **barcode** shown on the menu. Then enter the product code — see step 3.

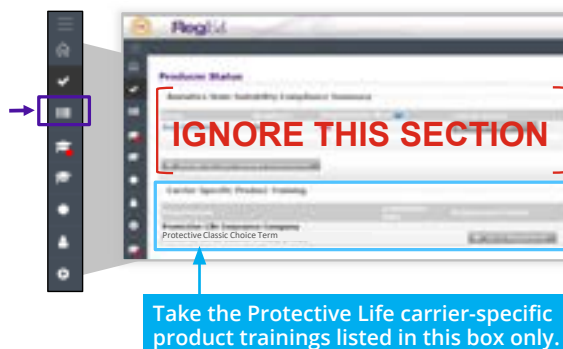

3. Enter the product code

Enter the appropriate product code, then click the **Submit** button. The course will then show up under the **Carrier-Specific Product Training** section.

Product codes — Life	Course title
PCCTNY	Protective Classic Choice term
PICULNY	Protective Indexed Choice UL

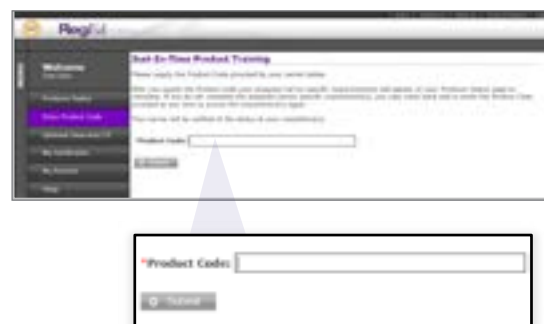

Additional information on next page.

Protective refers to Protective Life Insurance Company and Protective Life and Annuity Insurance Company.

For Financial Professional Use Only. Not for Use With Consumers.

4. Go to requirement

Click **Go To Requirement** located next to the applicable course name on the **Producer Status** screen.



5. Take the course

Use the forward arrow to advance through the course.



6. Complete the process

To complete the process, you'll need to attest to completing the course in its entirety. Click the box labeled **A** under **Answers**. Then click **Continue**. And then click **Close Window**.

Note:

For additional questions regarding the RegEd site, click the FAQ tab located on the Main Menu.

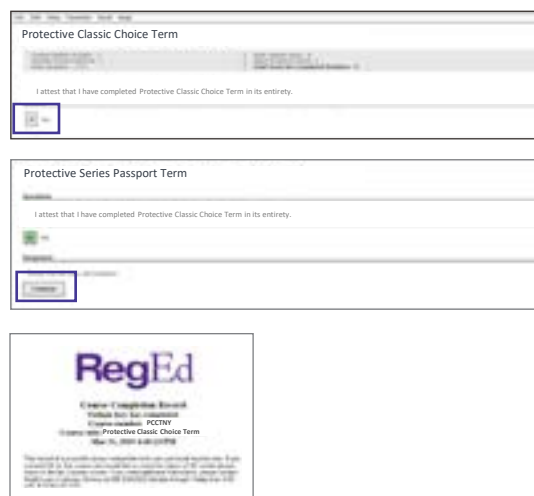

Protective refers to Protective Life Insurance Company (PLICO) located in Nashville, TN and its affiliates, including Protective Life and Annuity Insurance Company (PLAIC) located in Birmingham, AL. Protective® is a registered trademark of PLICO. The Protective trademarks, logos, and service marks are property of PLICO and are protected by copyright, trademark, and/or other proprietary rights and laws.

CLA.2720912 (10.23)

protective.com

For Financial Professional Use Only. Not for Use With Consumers.

Not FDIC/NCUA Insured	Not Bank or Credit Union Guaranteed	Not a Deposit
Not Insured By Any Federal Government Agency		May Lose Value